

FIG. 0730 SERIES FLUSH LATCH SET

MOUNTING INSTRUCTIONS

Read all instructions before proceeding.

This series of flush lock sets is designed to be mounted on doors 3/4 inch to 1-1/2 inches thick.

- 1). Tape Template 1 on door at the desired location.
- 2). Mark through template for two 7/16" diameter holes ("A") and two 9/32" diameter holes ("B")
- 3). Drill all 4 holes.
- 4). Tape Template 2 on door at the desired location Lining up Holes "C" and the centerline reference (C/L) with Template 1.
- 5). Mark through Template 2 for two 3/32" diameter holes ("C") and two 5/8" diameter holes ("D").
- 6). Drill ("C") holes 1 inch deep and ("D") holes 2-3/16" deep.
- 7). Rout door out to depth ("E") shown on template between the two 5/8" diameter holes using a 1/2 inch diameter routing bit.
- 8). Rout door out to depth ("F") shown on template using a 3/4 inch diameter routing bit.
- 9). Remove handles and separate the escutcheons Slide case assembly into door.
- 10). Fasten case assembly to door with (2) #6 flat head screws. (Supplied).
- 11). Refasten escutcheons. Attach 'L' handles to the shaft and install in lock set with square washers. Tighten set screws on lever handles.
- 12). Mount strike plate to door frame with (2) #6 flat head screws (Supplied).

<i>Catalog No.</i>	<i>Door Size</i>	<i>Type of Lock</i>
0730001LIC	3/4	Left Inward
0730001LOC	3/4	Left Outward
0730001RIC	3/4	Right Inward
0730001ROC	3/4	Right Outward
0730002LIC	1	Left Inward
0730002LOC	1	Left Outward
0730002RIC	1	Right Inward
0730002ROC	1	Right Outward
0730003LIC	1-1/4	Left Inward
0730003LOC	1-1/4	Left Outward
0730003RIC	1-1/4	Right Inward
0730003ROC	1-1/4	Right Outward
0730004LIC	1-1/2	Left Inward
0730004LOC	1-1/2	Left Outward
0730004RIC	1-1/2	Right Inward
0730004ROC	1-1/2	Right Outward

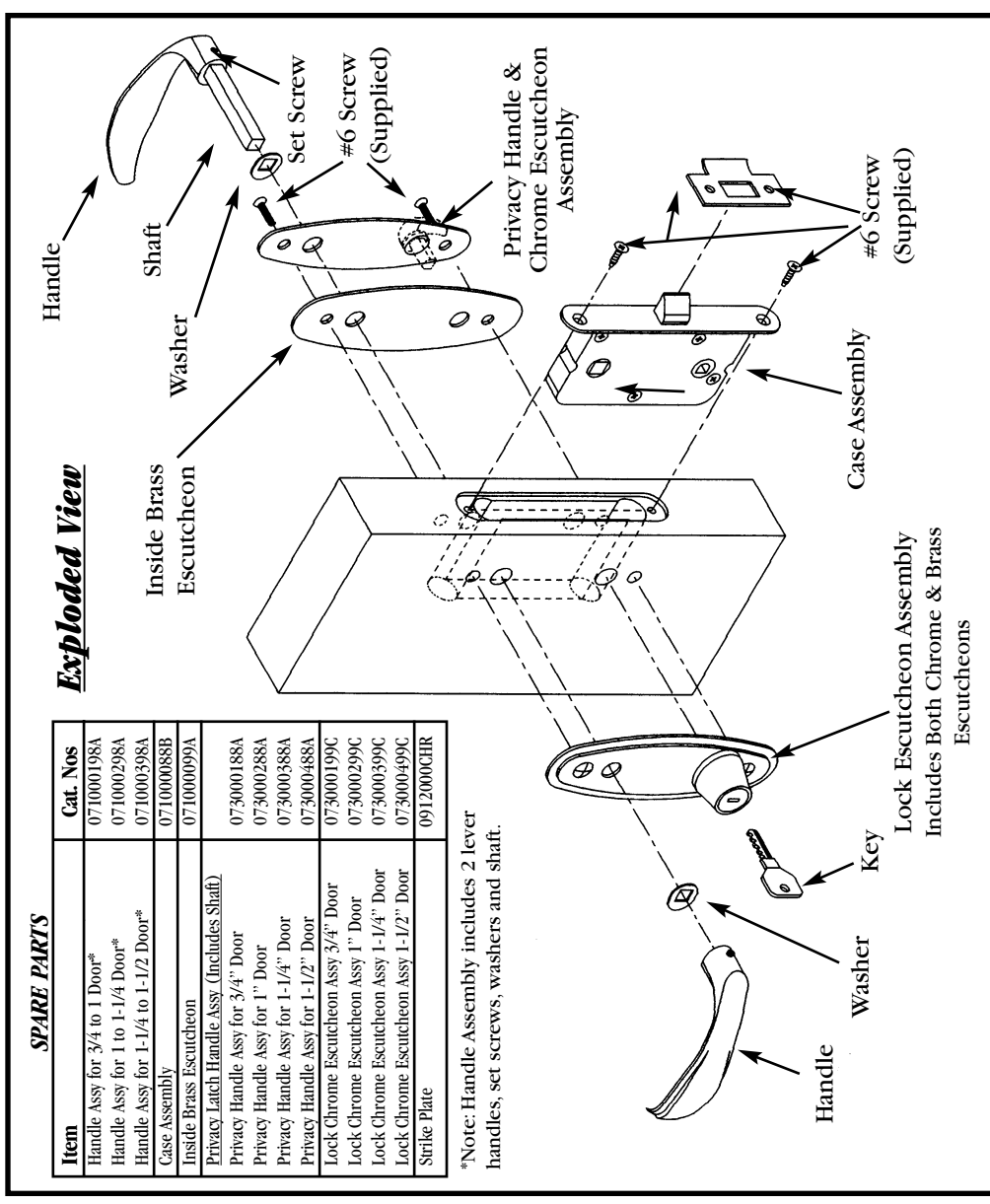

DETERMINING THE HAND OF THE LATCH SET.

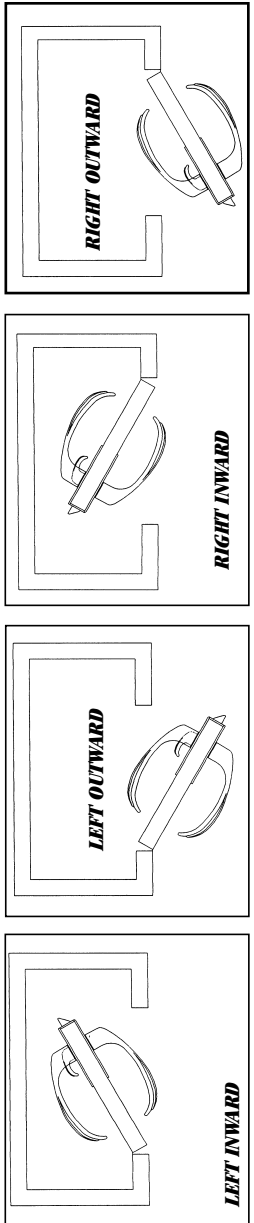

NOTE: The privacy latch handle should always be mounted on the door's interior side